



**CHT**  
DEVELOPMENTS

# SALES INFORMATION

1115 Heaphy Terrace



N NORTH ELEVATION



E EAST ELEVATION



# FLOOR AREAS OVER TIMBER FRAME

UNIT	G.FLOOR	U.FLOOR	TOTAL
1	77.26m <sup>2</sup>	49.39m <sup>2</sup>	126.65m <sup>2</sup>
2	77.26m <sup>2</sup>	49.39m <sup>2</sup>	126.65m <sup>2</sup>
	154.52m <sup>2</sup>	98.78m <sup>2</sup>	253.30m <sup>2</sup>
3	101.01m <sup>2</sup>	-	101.01m <sup>2</sup>
	101.01m <sup>2</sup>	-	101.01m <sup>2</sup>
TOTAL	255.53m <sup>2</sup>	98.78m <sup>2</sup>	354.31m <sup>2</sup>

# FLOOR AREAS OVER BRICK VENEER

UNIT	G.FLOOR	U.FLOOR	TOTAL
1	79.55m <sup>2</sup>	50.06m <sup>2</sup>	129.61m <sup>2</sup>
2	79.55m <sup>2</sup>	50.06m <sup>2</sup>	129.61m <sup>2</sup>
	159.10m <sup>2</sup>	100.12m <sup>2</sup>	259.22m <sup>2</sup>
3	105.72m <sup>2</sup>	-	105.72m <sup>2</sup>
	105.72m <sup>2</sup>	-	105.72m <sup>2</sup>
TOTAL	264.82m <sup>2</sup>	100.12m <sup>2</sup>	364.94m <sup>2</sup>

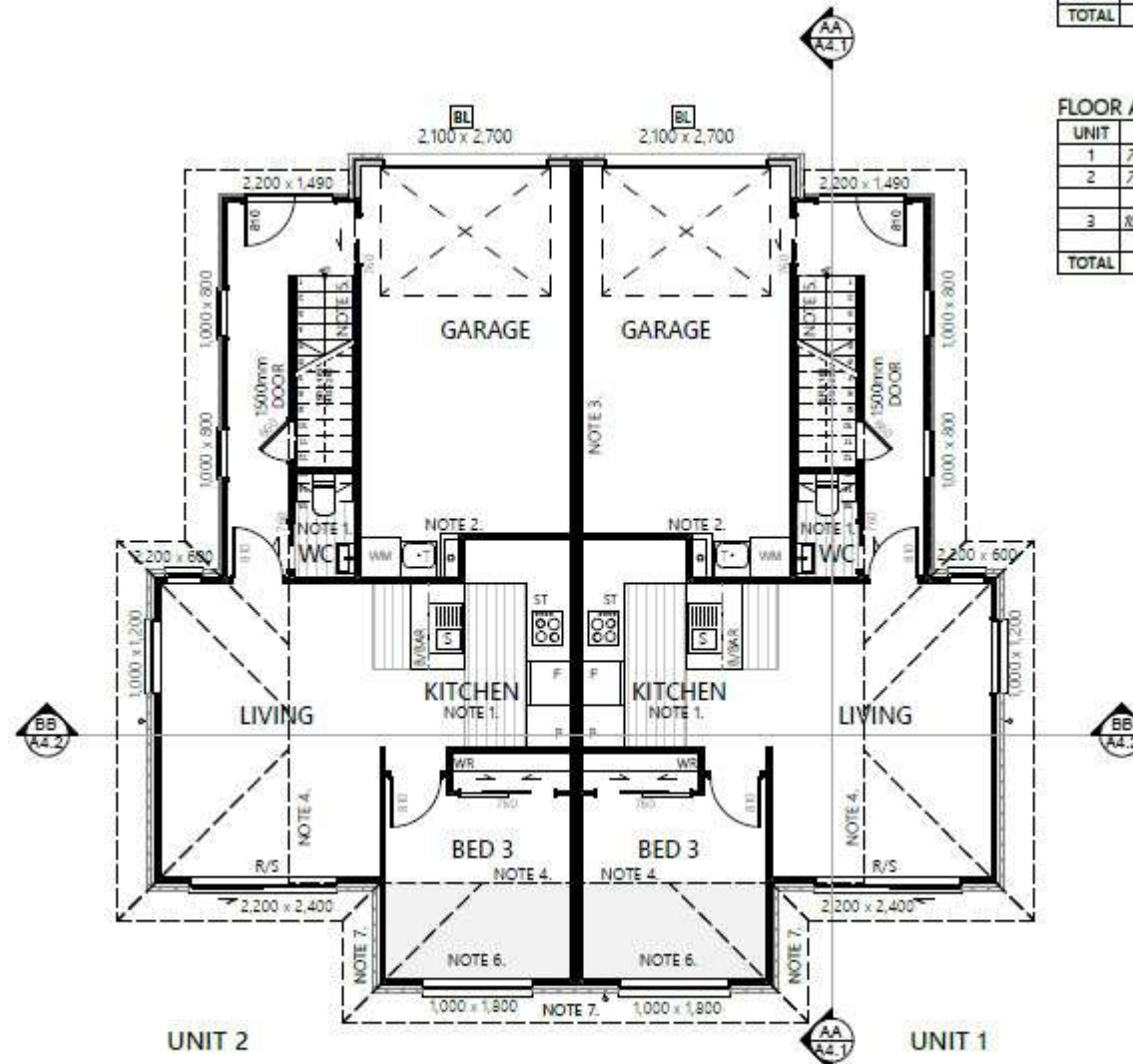

**A1 GROUND FLOOR PLAN**  
STUD HEIGHT TO BE 2.455m



ELEVATION MARKER



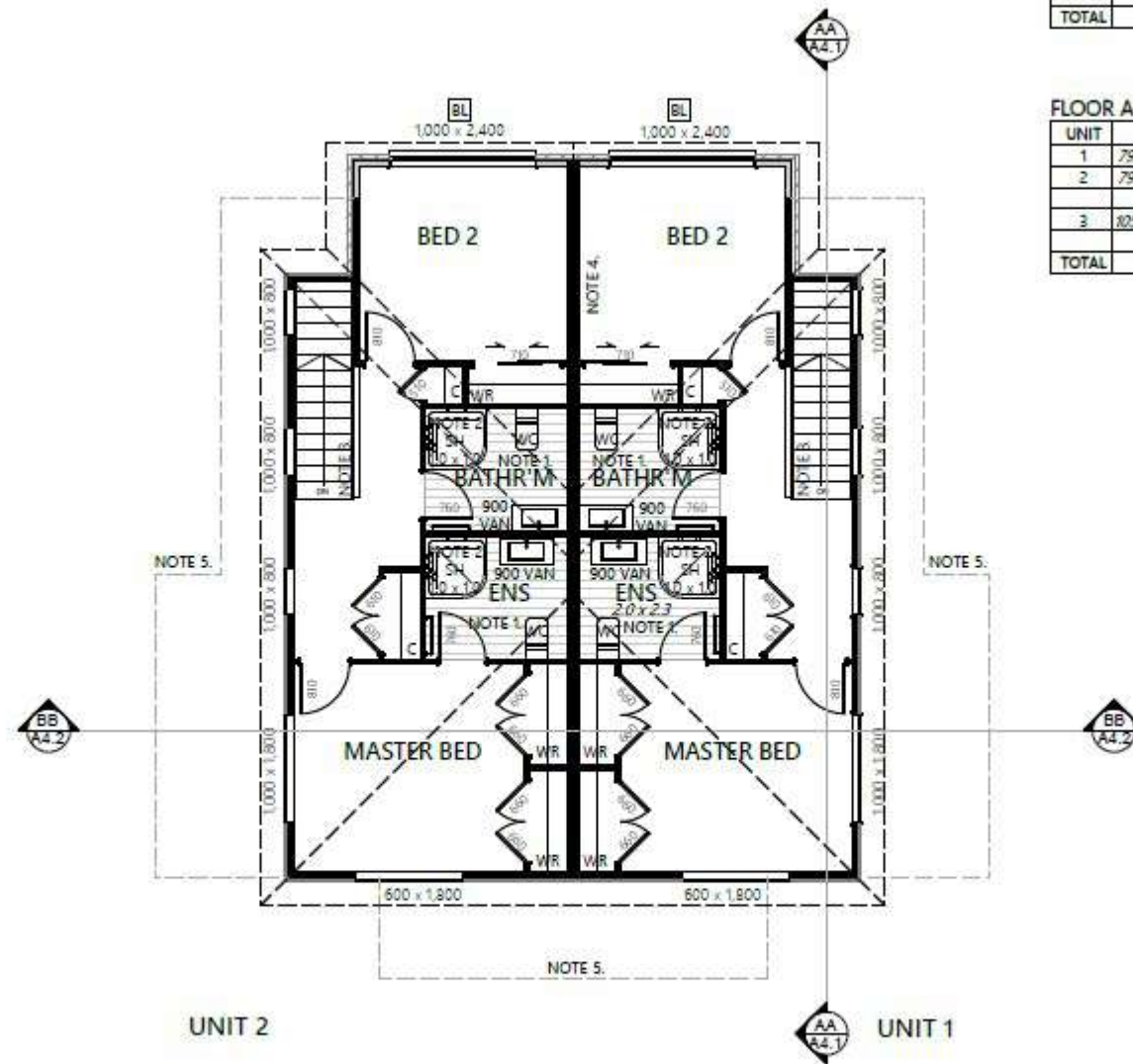

1 FIRST FLOOR PLAN  
STUD HEIGHT TO BE 2.455m

#### FLOOR AREAS OVER TIMBER FRAME

UNIT	G.FLOOR	U.FLOOR	TOTAL
1	77.26m <sup>2</sup>	49.39m <sup>2</sup>	126.65m <sup>2</sup>
2	77.26m <sup>2</sup>	49.39m <sup>2</sup>	126.65m <sup>2</sup>
	154.52m <sup>2</sup>	98.78m <sup>2</sup>	253.30m <sup>2</sup>
3	101.01m <sup>2</sup>	-	101.01m <sup>2</sup>
	101.01m <sup>2</sup>	-	101.01m <sup>2</sup>
TOTAL	255.53m <sup>2</sup>	98.78m <sup>2</sup>	354.31m <sup>2</sup>

#### FLOOR AREAS OVER BRICK VENEER

UNIT	G.FLOOR	U.FLOOR	TOTAL
1	79.55m <sup>2</sup>	50.06m <sup>2</sup>	129.61m <sup>2</sup>
2	79.55m <sup>2</sup>	50.06m <sup>2</sup>	129.61m <sup>2</sup>
	159.10m <sup>2</sup>	100.12m <sup>2</sup>	259.22m <sup>2</sup>
3	105.72m <sup>2</sup>	-	105.72m <sup>2</sup>
	105.72m <sup>2</sup>	-	105.72m <sup>2</sup>
TOTAL	264.82m <sup>2</sup>	100.12m <sup>2</sup>	364.94m <sup>2</sup>



ELEVATION MARKER



## **SPECIFICATIONS**

1115 Heaphy Terrace, Fairfield

021 252 9648  
63 Vickery Street Te Rapa  
[info@chtd.co.nz](mailto:info@chtd.co.nz)



# EXTERIOR

## Specification

### **Joinery Type**

35mm Architectural suite, powder-coated finish

### **Cladding One**

Midland Classic Red Brick

### **Cladding Two**

James Hardie 180mm Linea Weatherboard painted

### **Fascia & Spouting**

150 Coloursteel Fascia and ¼ Round Spouting

### **Downpipes**

80mm round PVC

### **Roofing & Soffits**

Metrotile metal tile roofing (Shake Satin), James Hardie Soffits Painted

### **Windows**

Double glazed, aluminium joinery

### **Parking**

Single car garage (unit 1 & 2 only), off-street parking

### **Front Entry Door**

Aluminium PTF tongue and groove door panel

### **Entrance Hardware**

Schlage S-6000 digital touchpad lever



# EXTERIOR FINISHES

## Specification

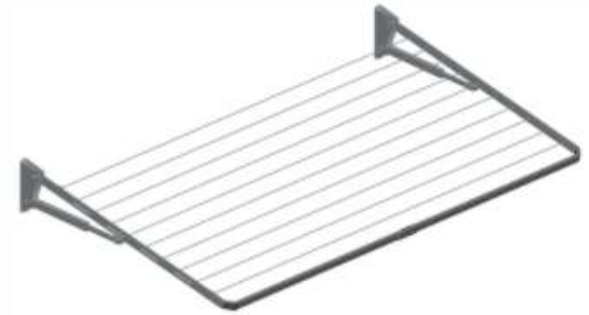

### Landscaping

As per resource consent plans

### Fencing

As per resource consent plans

### Concrete

Natural grey concrete driveway and patios as per plan.

### Clothesline

Included - Single Folding attached to the fence or house

### Letterbox

Included - Standard Metal letterbox

021 252 9648  
63 Vickery Street Te Rapa  
[info@chtd.co.nz](mailto:info@chtd.co.nz)





# INTERIOR

## Specification

### **Insulation**

R2.2 wall and R3.6 ceiling batts

### **Interior Lining**

Standard 10mm Gib® Plasterboard to walls, with 13mm to ceilings Gib® Aqualine plasterboard to wet areas.

### **Scotia, Skirting & Architraves**

55mm GIB cove 'Classic' throughout, 60mm bevelled Skirting & Architraves.

### **Interior Doors**

1980mm MDF hollow core doors, Smooth finish.

### **Gib Stopping**

To a level 4 paint finish.

### **Painting**

All interior. Exterior: Soffits where required, & Weatherboards.

### **Hot Water**

Rinnai A26 External Infinity, 26L on natural gas.

### **Electrical**

Includes LED Downlights & Power Outlets throughout.

### **Heating**

High wall heatpump in living to meet healthy homes requirements



# INTERIOR FINISHES

## Specification



### **Kitchen Cabinetry**

### **Benchtop**

### **Splashback**

### **Carpet**

### **Flooring**

### **Door Hardware**

18mm Coloured Melteca with 1mm PVC edges

37mm Laminate Benchtop

City White tiles to the kitchen behind hob/two tiles high above vanities

3kg Casa Bella Solution dyed nylon on 12mm Luxury Underlay

Moduleo Select Vinyl Planking

Schlage Element Series. Satin Chrome Finish



021 252 9648  
63 Vickery Street Te Rapa  
[info@chtd.co.nz](mailto:info@chtd.co.nz)



# PLUMBING

## Specification



**Shower**

**Toilet**

**Mixers**

**Vanities**

**Mirror**

**Laundry Tub**

**HTR**

Robertson Elementi moulded wall acrylic showers

Robertson Uno back-to-wall toilet suite

Robertson Verona mixers, Elementi Splash 3- function sliders

Surrey Slim Wall Hung. New Tech Frank 900mm White

5mm flat polish edge glass

Robinhood Slim tub

Included

021 252 9648  
63 Vickery Street Te Rapa  
[info@chtd.co.nz](mailto:info@chtd.co.nz)



# APPLIANCES

## Specification



**Oven**

**Cooktop**

**Rangehood**

**Dishwasher**

**Waste Disposal**

**Fridge**

Robinhoo OBD605K645SS 5-Function Built-in oven

Robinhoo HGA604FKSS gas cooktop

Ariston ARU75AX-L powerpack

Robinhoo DWM12P6FSS 60cm dishwasher

Robinhoo SEN500QA waste disposal with air switch

Not Included

021 252 9648  
63 Vickery Street Te Rapa  
[info@chtd.co.nz](mailto:info@chtd.co.nz)



# SHELVING

## Specification

### Wardrobes

### Cupboards and Storage

Single shelf with hanging, 18mm white Melteca, 300mm deep, 1700mm high.  
white wire ventilated shelves, 400mm deep, 1700mm high



021 252 9648  
63 Vickery Street Te Rapa  
[info@chtd.co.nz](mailto:info@chtd.co.nz)







# IMAGES

(Artist Impressions Only)

021 252 9648  
63 Vickery Street Te Rapa  
[info@chtd.co.nz](mailto:info@chtd.co.nz)

















